

### Glands, seal rings & adapters

- 426 EPIC® SM/SP/CM gland kits
- 427 D series pressure screws
- 427 U series washers
- 427 E series neoprene concentric sealing rings
- 427 EV series Viton® concentric sealing rings
- 428 PG/NPT/metric adapters
- 428 PG & metric reducers
- 428 PG & metric enlargers
- 428 Metal hole plugs

### Dust covers

- 429 EPIC® HA dust covers
- 429 EPIC® HB dust covers
- 429 EPIC® ULTRA dust covers 

### Tools

- 430 EPIC® rectangular hole punch  
For EPIC® HB panel mount bases and SKINTOP® multi-cable bushing systems
- 431 Easy Strip 2  
Stripping & cutting tool
- 431 Crimp tool & case
- 431 Module removal tool  
For EPIC® MC series inserts
- 431 Adjustable torque screwdriver

### Replacement parts

- 432 Flat gaskets
- 432 Replacement parts  
For EPIC® rectangular inserts
- 432 Replacement parts  
For EPIC® rectangular housings

### Coding pins

- 433 **Coding with key pin**
- 433 **Coding with guide pin & socket**  
For screw, crimp & cage clamp termination
- 433 **Coding with contact loss**

### Split hoods

- 434 **HB split hoods with double latch bolts**  
For EPIC® HB 16 & HB 24 housings
- 434 **Split hood grommets**

### Adapter plates

- 435 **Cover plates for panel cutouts**
- 435 **Adapters for D-sub connectors**

### DIN rail mounting system

- 436 **EPIC® QUICK & EASY DIN rail mounting system**

# EPIC® SM/SP/CM gland kits

EPIC® SM



EPIC® SP



EPIC® CM

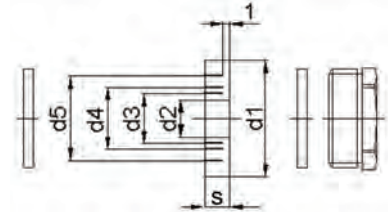

## Technical data

<b>Material:</b> - EPIC® SM & CM: - EPIC® SP:	nickel-plated brass	<b>Temperature range:</b> - EPIC® SM & CM: - EPIC® SP:	-40 °C to +125 °C
	polystyrol		-20 °C to +55 °C
<b>IP Protection class:</b> - EPIC® CM:		IP54 (DIN 46320)	

## EPIC® SM

Part number	Size	d1 mm	mm	d2 cable OD	mm	d3 cable OD	mm	d4 cable OD	mm	d5 cable OD	mm	s mm	Wrench size mm	Pack size
<b>PG thread</b>														
12954200	PG 11	16.5	7.5	6.5 - 8.5	10	9 - 11	12.5	11.5 - 13.5	—	—	6	18	5	
12954300	PG 13	18.3	7.5	6.5 - 8.5	10	9 - 11	12.5	11.5 - 13.5	—	—	6	20	5	
12954400	PG 16	20.4	7.5	6.5 - 8.5	10	9 - 11	12.5	11.5 - 13.5	15	14 - 16	7	22	5	
12954500	PG 21	25.9	10	9 - 11	13	12 - 14	16	15 - 17	19	18 - 20	8	28	5	
12954600	PG 29	34.7	18	17 - 19	21	20 - 22	24	23 - 25	27	26 - 28	9.5	37	5	
12954700	PG 36	44.7	24	23 - 25	27	26 - 28	30	29 - 31	33	32 - 34	12	47	5	
12954800	PG 42	51.7	30	29 - 31	33	32 - 34	36	35 - 37	39	38 - 40	14	54	5	
<b>Metric thread</b>														
71200000	M12	10	5	4 - 6	—	—	—	—	—	—	5	12	5	
71200200	M20	17.6	4	3 - 5	7	6 - 8	10	9 - 11	13	12 - 14	6	20	5	
71200300	M25	22.6	8.5	7.5 - 9.5	11.5	10.5 - 12.5	14.5	13.5 - 15.5	17.5	16.5 - 18.5	7.5	25	5	
71200400	M32	29.6	16	15 - 17	19	18 - 20	22	21 - 23	25	24 - 26	9.5	32	5	
71200500	M40	37.6	23	22 - 24	26	25 - 27	29	23 - 28	32	31 - 33	12	40	5	

## EPIC® SP

Part number	Size	d1 mm	mm	d2 cable OD	mm	d3 cable OD	mm	d4 cable OD	mm	d5 cable OD	mm	s mm	Wrench size mm	Pack size
<b>PG thread</b>														
12957100	PG 11	16.5	7.5	6.5 - 8.5	10	9 - 11	12.5	11.5 - 13.5	—	—	6	19	5	

## EPIC® CM



Part number	Size	d1 mm	mm	d2 cable OD	mm	d3 cable OD	mm	d4 cable OD	mm	d5 cable OD	mm	s mm	Wrench size mm	Pack size
<b>Metric thread</b>														
71201200	M20	17.6	4	3 - 5	7	6 - 8	10	9 - 11	13	12 - 14	6	23	5	
71201300	M25	22.6	8.5	7.5 - 9.5	11.5	10.5 - 12.5	14.5	13.5 - 15.5	17.5	16.5 - 18.5	7.5	28	5	
71201400	M32	29.6	16	15 - 17	19	18 - 20	22	21 - 23	25	24 - 26	9.5	36	5	
71201500	M40	37.6	23	22 - 24	26	25 - 27	29	23 - 28	32	31 - 33	12	46	5	

If not otherwise specified, all values relating to the product are nominal values. Photographs are not to scale and are not true representations of the products in question.

## D series pressure screws



### Technical data



-  **Material:** nickel-plated brass
-  **Specifications:** DIN 46320

Part number	Size	Wrench size mm	Pack size
52100200	PG 7	13	100
52100220	PG 11	18	100
52100240	PG 16	22	50
52100250	PG 21	28	50
52100260	PG 29	37	25
52100270	PG 36	47	10

## U series washers



### Technical data

-  **Material:** galvanized steel
-  **Specifications:** DIN 46320

Part number	Size	External diameter mm	Internal diameter mm	Thickness mm	Pack size
52010170	PG 7	11	8	0.8	100
52010180	PG 9	13.5	10	0.8	100
52010190	PG 11	17	12	0.8	100
52010200	PG 13	18.5	14	0.8	100
52010210	PG 16	20.5	16	0.8	50
52010220	PG 21	26	21	0.8	50
52010230	PG 29	35	30	0.8	25
52010240	PG 36	45	38	0.8	10

## E series neoprene concentric sealing rings



### Technical data

-  **Material:** neoprene



These rings can be individually adapted to various cable diameters by removing the appropriate sizes. They are also suitable for half glands.

Part number	Size	External diameter mm	Concentric bores mm	Pack size
52005780	PG 9	13.5	5 • 8	500
52003690	PG 11	16.5	7 • 10 • 12.5	500
52003700	PG 13	18.5	7 • 10.5 • 13 • 16	500
52003710	PG 16	20.5	8 • 10.5 • 13.5 • 16	500
52003720	PG 21	26	11 • 15 • 18 • 20	100
52003730	PG 29	35	19 • 23 • 27 • 31	100
52003740	PG 36	45	25 • 28 • 31 • 35	50

## EV series Viton® concentric sealing rings



### Technical data

-  **Material:** Viton®
-  **Temperature range:** up to +165 °C

These rings can be individually adapted to various cable diameters by removing the appropriate sizes. They are also suitable for half glands.

Part number	Size	External diameter mm	Concentric bores mm	Pack size
52010340	PG 11	16.5	7 • 10 • 12.5	50
52010350	PG 13	18.5	7 • 10.5 • 13 • 16	50
52010370	PG 21	26	11 • 15 • 18 • 20	25
52010380	PG 29	35	19 • 23 • 27 • 31	25

Viton® is a registered trademark of E.I. du Pont de Nemours and Company.

If not otherwise specified, all values relating to the product are nominal values. Photographs are not to scale and are not true representations of the products in question.

## PG/NPT/metric adapters



### Technical data

**Material:** nickel-plated brass  
brass

**Specifications:** DIN 46320

For product information and part numbers, see page 552

## PG & metric reducers



### Technical data

**Material:** nickel-plated brass

**Specifications:** DIN 46320

For product information and part numbers, see page 550

## PG & metric enlargers



### Technical data

**Material:** nickel-plated brass

**Specifications:** DIN 46320

For product information and part numbers, see page 551

## Metal hole plugs



Hole plugs are for use when existing PG-threaded holes are not yet or no longer required. For product information and part numbers, see page 549.

### Technical data

**Material:** nickel-plated brass

### Complete the installation



Blind hood  
plug:  
10053010

## EPIC® HA dust covers



EPIC® HA series protective covers are made of impact-resistant plastic, which provides effective protection against environmental influences. Inserts are easily protected when not in use. EPIC® HA 3/4 covers are for use with surface mount bases, panel mount bases, and cable coupler hoods.

### Technical data

<b>Material:</b>	thermoplastic resin aluminum
<b>Temperature range:</b>	-40°C to +125°C

Part number with string	Part number without string	Material	Description	Gasket
<b>HA 3/4</b>				
10430400	10430000	plastic	for housing with plug	no
10430100	10430300	plastic	for housing with receptacle	yes
10513000	—	metal	for housing with plug	no
10513100	—	metal	for housing with receptacle	yes
<b>HA 10</b>				
10457600	10457800	plastic	for hoods	no
10457500	10457700	plastic	for bases & couplers	yes

Part number with string	Part number without string	Material	Description	Gasket
<b>HA 16</b>				
10469600	10469800	plastic	for hoods	no
10469500	10469700	plastic	for bases & couplers	yes
<b>HA 32</b>				
10481600	10481800	plastic	for hoods	yes
10481500	10481700	plastic	for bases & couplers	no
<b>HA 48</b>				
10118020	—	plastic	for bases & couplers	no

## EPIC® HB dust covers



EPIC® HB series protective covers are made of impact-resistant plastic, which provides effective protection against environmental influences. Inserts are easily protected when not in use. Attachment string is included with all dust covers.

### Technical data

<b>Material:</b>	thermoplastic resin
------------------	---------------------

Part number	Lever or bolts	Description	Gasket
<b>HB 6</b>			
10016500	single lever	for hoods	yes
10015000	single lever bolts	for bases & couplers	no
<b>HB 10</b>			
10048600	single lever	for hoods	no
10048700	single lever bolts	for bases & couplers	no
10048500	double levers	for hoods	yes
10047000	double lever bolts	for bases & couplers	no
<b>HB 16</b>			
10088600	single lever	for hoods	no
10088700	single lever bolts	for bases & couplers	no
10088500	double levers	for hoods	yes
10087000	double lever bolts	for bases & couplers	no

Part number	Lever or bolts	Description	Gasket
<b>HB 24</b>			
10118600	single lever	for hoods	no
10118700	single lever bolts	for bases & couplers	no
10119500	double levers	for hoods	yes
10118000	double lever bolts	for bases & couplers	no
<b>HB 32</b>			
10118020	double lever bolts	for bases & couplers	no

## EPIC® ULTRA dust covers



### Technical data

<b>Material:</b>	FDA-approved plastic stainless steel
- cover:	FDA-approved plastic
- bolts & levers:	stainless steel

Part number	Lever or bolts	Description
<b>ULTRA HB 6</b>		
70250254	single lever	for hoods
70250250	single lever bolts	for bases
<b>ULTRA HB 10</b>		
70250255	double levers	for hoods
70250251	double lever bolts	for bases

Part number	Lever or bolts	Description
<b>ULTRA HB 16</b>		
70250256	double levers	for hoods
70250252	double lever bolts	for bases
<b>ULTRA HB 24</b>		
70250257	double levers	for hoods
70250253	double lever bolts	for bases

If not otherwise specified, all values relating to the product are nominal values. Photographs are not to scale and are not true representations of the products in question.

# EPIC® rectangular hole punch

For EPIC® HB panel mount bases and SKINTOP® multi-cable bushing systems



EPIC® rectangular hole punches provide a quick, accurate means of cutting clearance holes for mounting EPIC® HB series rectangular panel mount bases and SKINTOP® CUBE/CUBE MULTI multi-cable bushing systems without sawing or filing. The dies include four drill guide holes for the base's screw mounting holes. Centering alignment marks are also included for easy squaring of the die with the panel cabinet. The unique 2-piece die configuration simplifies scrap slug removal.

The EPIC® hole punches can be used with mild steel up to 14 GA (2.0 mm) thickness or aluminum up to 10 GA (2.54 mm). These punches are intended for manual use with a ratchet or other suitable wrench or with a hand- or foot-operated hydraulic driver and ram using a 3/4" draw stud.

**Requirements for manual operation:** One draw stud set and one punch & die set in the required size

**Requirements for hydraulic operation:** One punch & die set in the required size and if needed, one 3/4" draw stud

## 3/4" x 7" draw stud

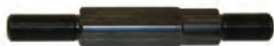

Part number
61U00198

## 3/4" x 7" draw stud set



Set includes: draw stud, drive nut, counter nut, ball bearing, and spacer

Part number
61U00197

## Punch & die sets



Size	Part number	Max. panel thickness
HB 6	61U00199	mild steel: 14 GA (2.0 mm) aluminum: 10 GA (2.54 mm)
HB 10	61U00200	
HB 16	61U00201	
HB 24	61U00203	

## Panel cutouts

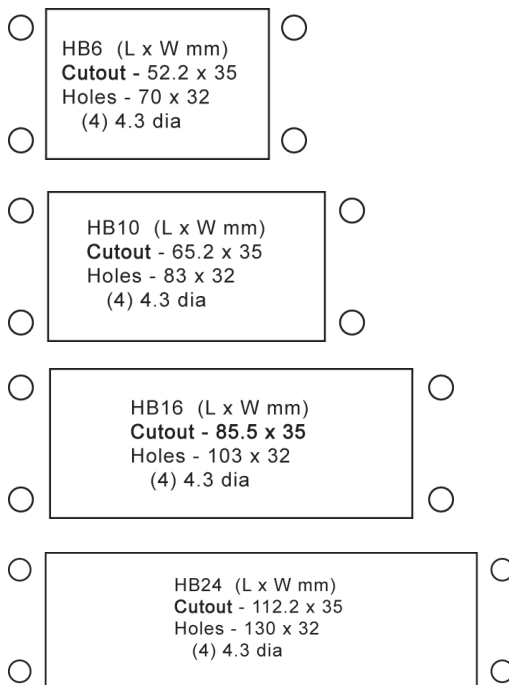

If not otherwise specified, all values relating to the product are nominal values. Photographs are not to scale and are not true representations of the products in question.

## Easy Strip 2

Stripping & cutting tool





For PVC and similarly insulated conductors.  
Includes "X" blade cartridge.

Size range	Part number
up to 8 AWG (10 mm <sup>2</sup> )	61735800

## Crimp tool & case



Contact tools

 Crimp dies page 289	 Locators page 289	 Removal tools page 289
--	--	---

Crimp range	Part number
26 - 8 AWG (0.14 - 10 mm <sup>2</sup> )	11147000

## Module removal tool

For EPIC® MC series inserts



For removing EPIC® MC series modules from module mounting frames  
Required for 3, 4+PE, 5, 10 & 20 contact modules; dummy, cage clamp, Ethernet & pneumatic modules

Part number
11171200

Approvals



## Adjustable torque screwdriver



Torque settings	Part number
0.3 - 1.2 Nm (2.7 - 10.6 in-lbs)	61813958

If not otherwise specified, all values relating to the product are nominal values.  
Photographs are not to scale and are not true representations of the products in question.

## Flat gaskets

For EPIC® HB & HA panel mount bases



### HB series

Part number	For EPIC® housing
10051000	HB 6
10051200	HB 10
10051400	HB 16
10051600	HB 24
10052000	HB 32
10052200	HB 48

### HA series

Part number	For EPIC® housing
10607100	HA 3/4
10607200	HA 10
10607300	HA 16
10607600	HA 32
10052000	HA 48
10052200	HA 64

### Approvals



## Replacement parts

For EPIC® rectangular inserts



Description	Part number	For EPIC® inserts	Pack size
Screw with O-ring	44423017	HD 7, HD 8	10
Replacement screw	44423018	STA	10
Male switch contact	44423021	HBVE	1

### Approvals



## Replacement parts

For EPIC® rectangular housings



Description	Part number	For EPIC® housings
Lever + 2x threaded lever-mounting bolts	10017101	HB 48, HA 64 panel mount bases
Black plastic roller	10055000	HB single lever housings
Plated steel clip	10056014	HB single lever housings
Heavy duty stainless steel roller	10055100	HB single lever housings
Heavy duty stainless steel clip	10056013	HB single lever housings

If not otherwise specified, all values relating to the product are nominal values. Photographs are not to scale and are not true representations of the products in question.

### Coding with key pin



Coding is used when several connectors are mounted next to one another. This helps prevent incorrect connections.

Part number	For EPIC® inserts	Pack size
10019000	HA, HBE, HEE, HBS, HBVE, HD, HDD, MC, Power K	50
10509000	STA	10

key positions for 1 insert

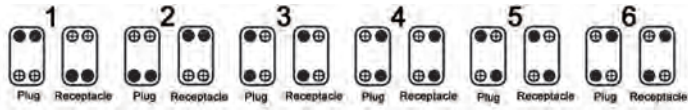

● key pin      ⊕ fixing screw

key positions for 2 inserts

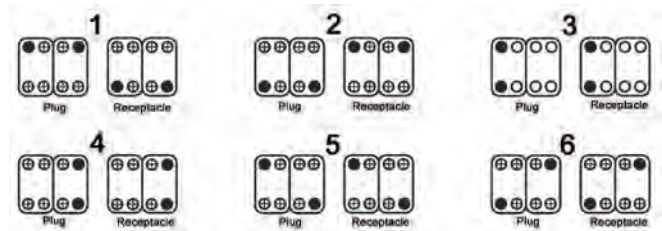

### Coding with guide pin & socket

For screw, crimp & cage clamp termination



Part number	For EPIC® inserts	Pack size
<b>Guide pin</b>		
11280000	HA, HBE, HBS, HBVE, HEE, HD, HDD, MC, Power K	50
<b>Guide socket</b>		
11281000	HA, HBE, HBS, HBVE, HEE, HD, HDD, MC, Power K	50

key positions for 1 insert

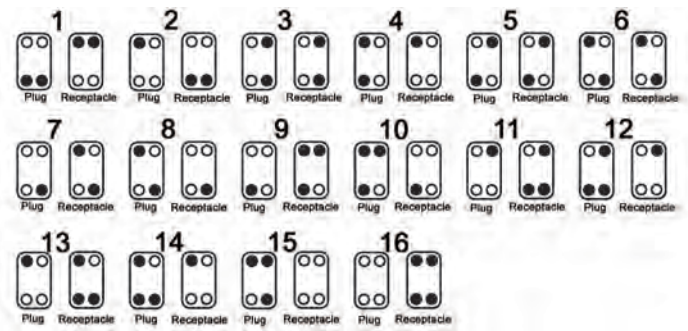

● guide pin      ○ guide socket      ⊕ fixing screw

key positions for 2 inserts

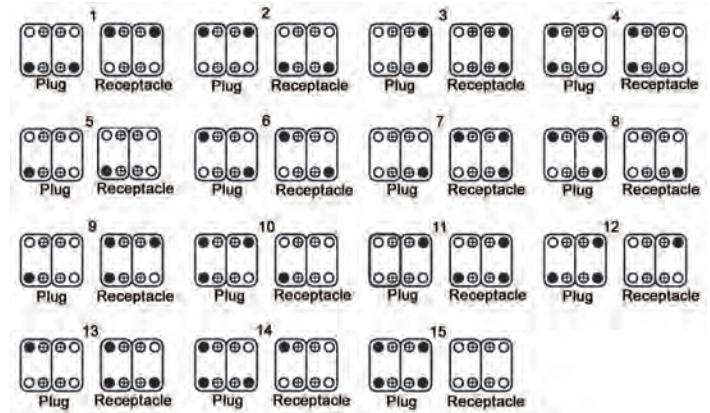

### Coding with contact loss

HA 3/4

HQ 5

HQ 12



Part number	For EPIC® inserts	Pack size
10451400	HA 3/4	50
10436500	HQ 5	10
44424052	HQ 12	10

If not otherwise specified, all values relating to the product are nominal values. Photographs are not to scale and are not true representations of the products in question.

## HB split hoods with double latch bolts

For EPIC® HB 16 & HB 24 housings

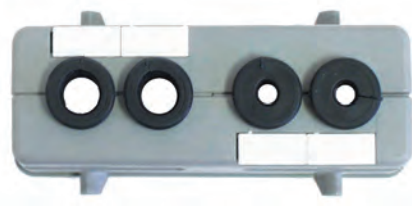

Split hoods allow three or four cable assemblies to pass through one hood, providing a convenient way to pass finished cables into a panel without having to re-terminate the assembly. A maximum of four cables ranging in size from 3 mm to 16 mm each may pass through a single hood.

Both the HBSH 16 and HBSH 24 hoods can accommodate any combination of the grommets listed below. When used with the grommets, the split hood provides an IP54 environmental seal.

Part number	Gland openings	Cable outer diameter	EPIC® HB panel mount base
HBSH16	3 openings	3 mm - 16 mm	100720C0
HBSH24	4 openings	3 mm - 16 mm	101020C0

## Split hood grommets



Thermoplastic rubber split grommets are available in a range of sizes. The grommets seal around the cables and provide IP54 protection as well as strain relief in the mated and assembled position. The HBSH 16 housing is capable of accommodating 3 glands; the HBSH 24 housing can accommodate 4 glands.

Technical data	
<b>Material:</b>	thermoplastic rubber (UL approved)
<b>Temperature range:</b>	-40°C to +140°C

Part number	Clamp range mm	Pack size
SHG 3	3 - 4	10
SHG 4	4 - 5	10
SHG 5	5 - 6	10
SHG 6	6 - 7	10
SHG 7	7 - 8	10
SHG 8	8 - 9	10
SHG 9	9 - 10	10

Part number	Clamp range mm	Pack size
SHG10	10 - 11	10
SHG11	11 - 12	10
SHG12	12 - 13	10
SHG13	13 - 14	10
SHG14	14 - 15	10
SHG15	15 - 16	10
SHG 0	blank	10

If not otherwise specified, all values relating to the product are nominal values. Photographs are not to scale and are not true representations of the products in question.

## Cover plates for panel cutouts

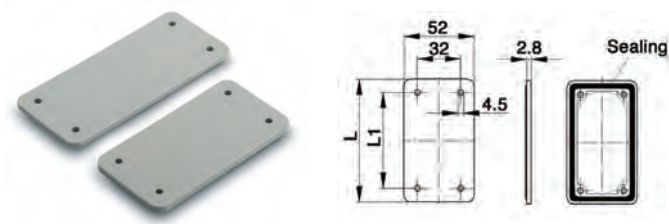

Part number	Size	Dimensions (mm)	
		L	L1
10018920	HB 6	90.5	70.0
10018921	HB 10	103.0	83.3
10018922	HB 16	123.5	103.0
10018923	HB 24	150.0	130.0

Plates do not include mounting screws

## Adapters for D-sub connectors

### Single D-sub connectors

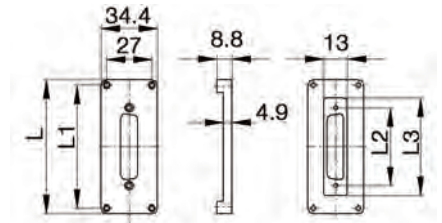

Part number	Size	DB cutout	L	Dimensions (mm)		
				L1	L2	L3
11764200	HB 6	DB 9	51.3	44.0	25.0	31.4
11764202	HB 6	DB 15	51.3	44.0	33.3	39.2

Part number	Size	DB cutout	L	Dimensions (mm)		
				L1	L2	L3
11764300	HB 10	DB 25	64.2	57.0	47.1	53.1
11764400	HB 16	DB 25	85.0	77.5	47.1	53.6

Includes mounting screws

### Double D-sub connectors

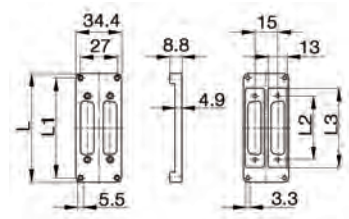

Part number	Size	DB cutout	L	Dimensions (mm)		
				L1	L2	L3
11764201	HB 6	DB 9 (x2)	51.3	44.0	25.0	31.4
11764203	HB 6	DB 15 (x2)	51.3	44.0	33.3	39.2

Part number	Size	DB cutout	L	Dimensions (mm)		
				L1	L2	L3
11764301	HB 10	DB 25 (x2)	64.2	57.0	47.1	53.1
11764401	HB 16	DB 25 (x2)	85.0	77.5	47.1	53.6

Includes mounting screws

If not otherwise specified, all values relating to the product are nominal values. Photographs are not to scale and are not true representations of the products in question.

# EPIC® QUICK & EASY DIN rail mounting system

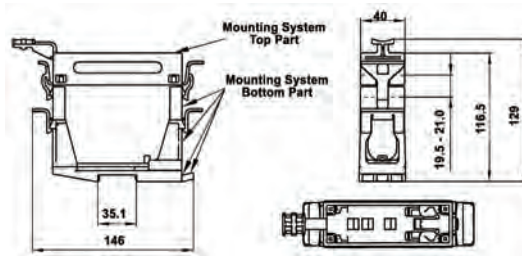
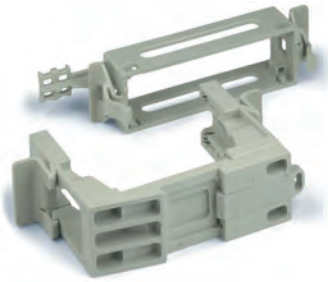

all dimensions are in mm



The EPIC® QUICK & EASY system greatly simplifies mounting a wide range of EPIC® connectors onto standard DIN rail without the added cost of housings. The system can be purchased as one complete unit or the upper and lower portions can be purchased separately. The upper portions come in 4 different sizes to accommodate EPIC® HBE, HEE, HBS, HDVE, HD, HDD & Modular (MC) contact inserts. The bottom portion of the system adjusts to accommodate 4 sizes. The system components lock in place via snap hooks and are directly mateable with existing systems. The slider latch allows for quick removal and attachment of the base from the DIN rail for wiring. Also, the unit can be labeled in three places with printed or handwritten labels. A special coding set with key pin allows for coding of the inserts to prevent mismatching side-by-side connectors.

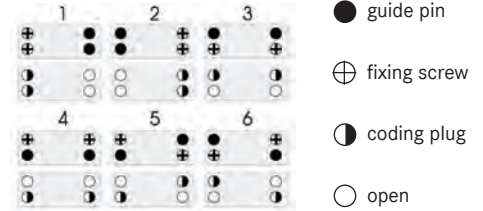

**Complete the installation**



Coding set (pack of 50): 10028000



Insert removal tool: 10028100

**Technical data**

<b>Locking device:</b>	for DIN rail acc. to DIN EN 50022	<b>Temperature range:</b>	-40°C to +125°C
<b>Material:</b>	gray phosphorus- & halogen-free polycarbonate	<b>Combustibility class:</b>	V-0 per UL 94

Part number	Size
<b>Complete system</b>	
10027000	HB 6
10027100	HB 10
10027200	HB 16
10027300	HB 24
<b>Upper part only</b>	
10027410	HB 6
10027510	HB 10
10027610	HB 16
10027710	HB 24
<b>Lower part only</b>	
10027810	HB 6 - 24

Size	For EPIC® inserts						
	HBE	HEE	HBS	HBVE	HD	HDD	MC
HB 6	HBE 6	HEE 10	—	—	—	HDD 24	MC 2
HB 10	HBE 10	HEE 18	—	HBVE 3	—	HDD 42	MC 3
HB 16	HBE 16	HEE 32	HBS 6	HBVE 6	HD 40	HDD 72	MC 5
HB 24	HBE 24	HEE 46	—	HBVE 10	HD 64	HDD 108	MC 7

six easy steps: click – snap – ready!

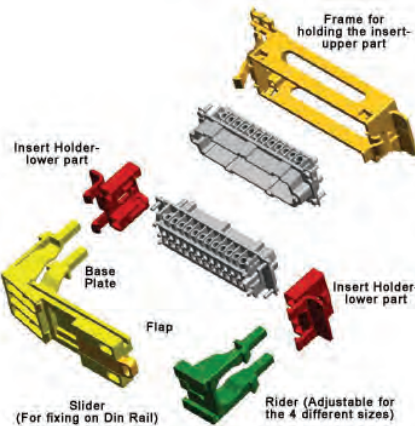
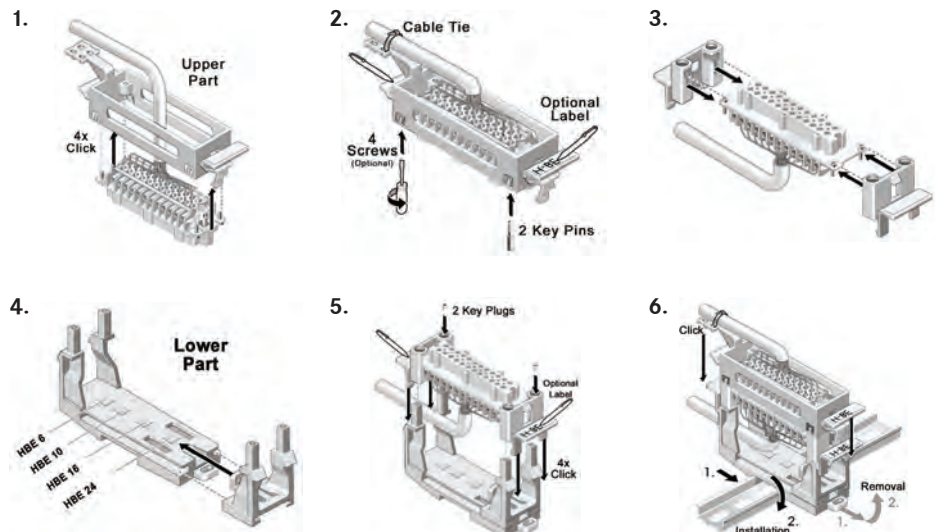

If not otherwise specified, all values relating to the product are nominal values. Photographs are not to scale and are not true representations of the products in question.